

## Net Weight Food Grade Filling Machine 1 to 5 Gallons

This net weight filling machine is IDEAL for packaging liquid or semi viscous food products into plastic 1 to 5 gallon containers. The machine is light and compact so it is easy to position in a manufacturing facility. The operator simply places a container on the scale and pushes the fill button. The container is tared and automatically filled by net or gross weight. Manually place a lid or cap and roll the container off the scale. Combining the filling machine with a roll through closing or capping machine further automates the packaging process.



Shown with Bottom Up Fill

## FEATURES

- Blue vacuum fluorescent 5" high weight display
- Clamped support on post for adjusting height of nozzle
- Oil dampened load cell
- Solid Delrin lift out rollers
- Stainless Steel frame
- Nema 4X Enclosure
- IP-65 Operators
- Sanitary product contact parts

**Model: SE1-RNS**



# IDEAL<sup>®</sup>

MANUFACTURING & SALES CORP.

Ideal Manufacturing & Sales Corp.  
4607 Dovetail Drive • Madison, WI 53704  
Toll Free: (800) 383-1128 • Local: (608) 241-1118  
[www.ideal-pak.com](http://www.ideal-pak.com)

May be covered by one or more of the following  
U.S. Patents: #5,505,233, #5,823,406, #6,148,877, #6,595,250



### Sizes

1/2 Pint	●	Pails
Pints		Kegs
Quart		Drums
● Gallons		Totes

### Machine Specifications

Electrical	120 VAC, 15 Amp, 60 Hz, 1Ø, Nema 4 X	
Air	4 SCFM @ 80 PSI (clean dry air)	
Container Size	1 and 5 gallon open top	
Speed*	1 Gallon	2 – 5 cpm
	5 Gallon	1 – 3 cpm
Accuracy**	To within $\pm$ .25 lb.	
<p>*Fill rates will vary depending on container size, container shape, fill opening, accuracy required, product supply, as well as individual product characteristics.</p> <p>**A consistent head pressure in the tank this machine will draw from, will help keep the fills accurate.</p>		

Since we continuously strive to improve our products, we reserve the right to make changes and modifications without notice.

## OPTIONS

- RS-232 Output
- Time and Date transmitting of each fill to peripheral devices
- Closers/Cappers
- Nozzles for smaller sizes to 1/2 pint
- Top filling
- Connectivity to Factory Automation

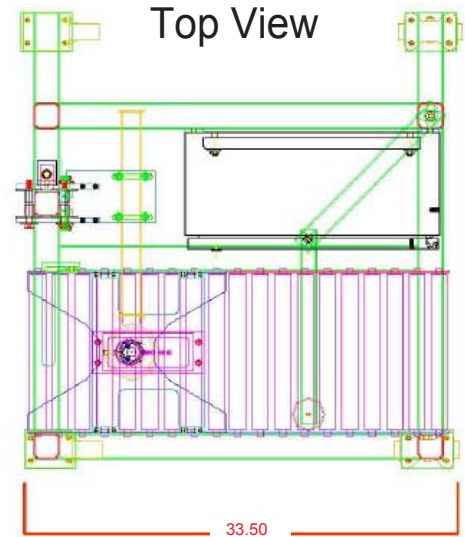

### Front View

